

mini **mop**

**the hardware companion  
of MadMapper**

*User guide*



miniMAD is a all-in-one dedicated device for video mapping, based on the Rapberry Pi platform.

It is easy to use, small and versatile, for your future video mapping projects.

[www.madmapper.com](http://www.madmapper.com)

Designed and developed by GarageCube and 1024 architecture

The miniMAD needs MadMapper or MadMapper Lite to setup your miniMAD projects.

## CONTENTS

<b>FEATURES</b>	<b>3</b>
Surfaces	
Medias	
Projectors	
Export to miniMAD	
Network synchronization	
<b>CONTROLS</b>	<b>6</b>
Buttons	
Keyboard	
Network synchronization	
<b>SPECIFICATIONS</b>	<b>8</b>
Technical Specifications	
In the box	
<b>ACCESSORIES</b>	<b>9</b>
Power Supply Lock	

# FEATURES

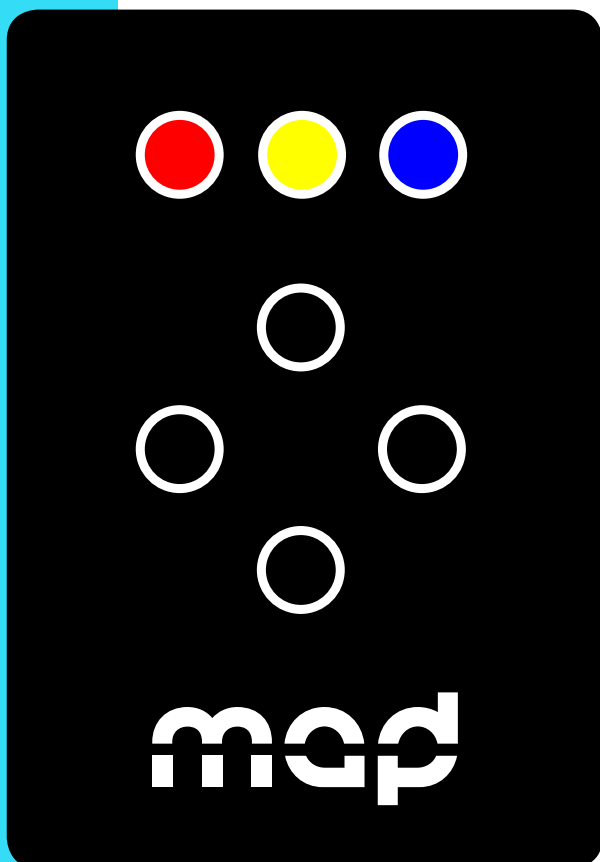

## SURFACES

miniMAD 3 supports quad\* and triangle surfaces. Other surfaces (Circle, Mask, fixtures, Lines, 3D Surfaces) are not supported yet.

*\* Quad masks and shaders are not yet supported*

## MEDIA

miniMAD 3 supports a single media at a time on every surfaces.

Every image files supported by MadMapper will be exported to miniMAD.

During the export process, movie files will be transcoded and their size adapted to maximize the performance depending on the selected projector's resolution.

## PROJECTORS

The device supports a single projector connected to the HDMI port.

The maximum supported resolution is 1080p (1920×1080).

In case the selected resolution is not supported by the actual connected projector, the device will use the projector's default resolution and display a notification.

# FEATURES

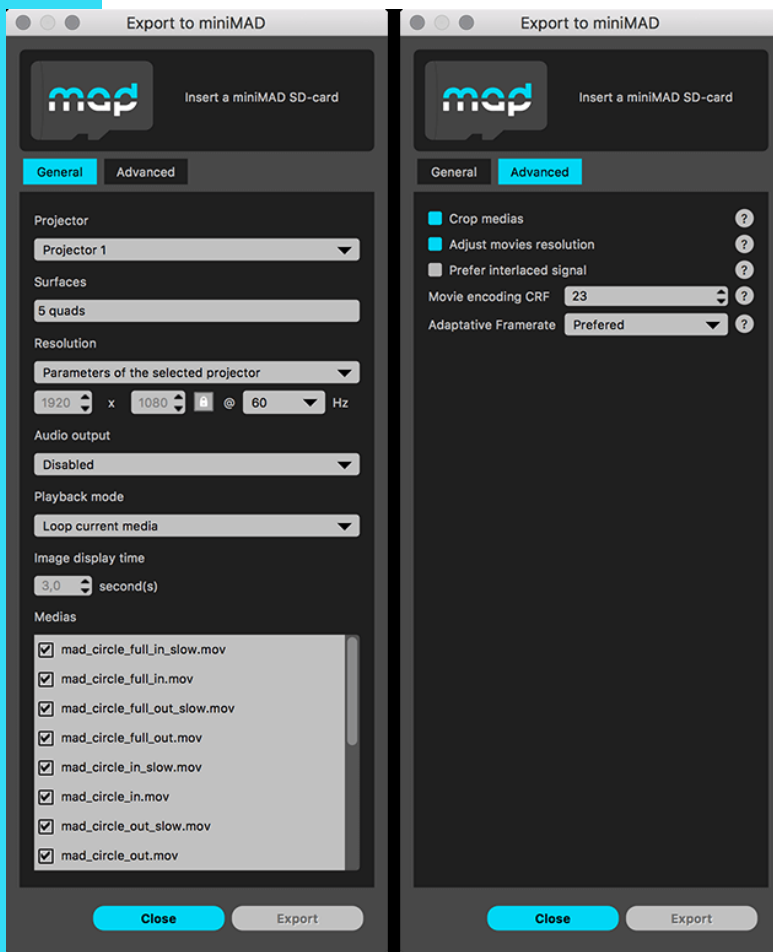

## EXPORT TO miniMAD

Insert the provided SD-card in your computer using the bundled microSD card adapter. If necessary, update miniMAD as advised before exporting.

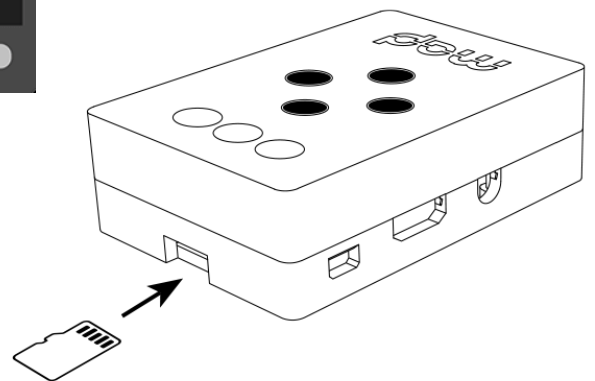

Then, select the projector you want to export to miniMAD, adjust the output resolution, the audio output, the playback options, optionally unselect and reorder your medias and highlight the default media to be played at startup.

Finally, click the “Export” button to start the export – FFmpeg Tools is required to export MadMapper project to miniMAD please download FFmpeg Tools Installer.

The process may take some time depending on the number of movie files and their duration. MadMapper will avoid transcoding movie files that are already optimized on the SD-card.

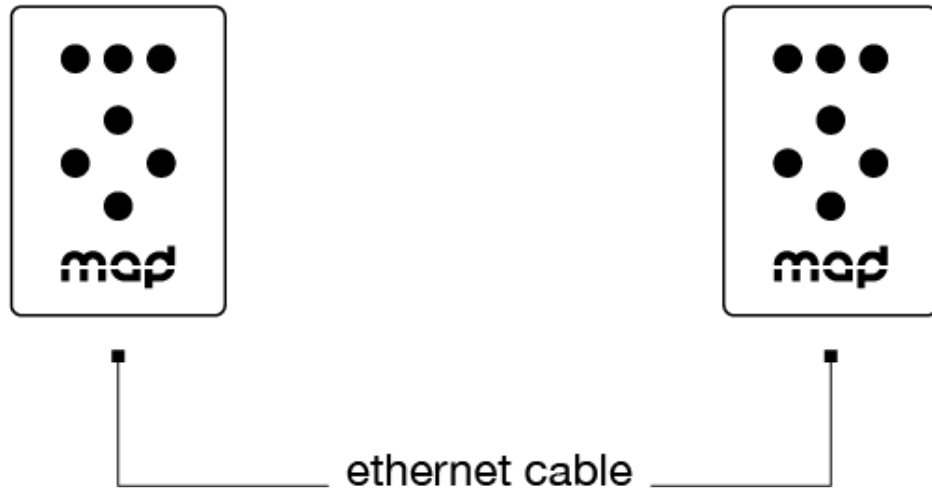

## NETWORK SYNCHRONIZATION

Connect the miniMADs on the same ethernet network to synchronize media-playback automatically\*.

*\* movie synchronization happens when the movies playing on every miniMADs have the same frame count and framerate, even though their file names are different*

Every media-related action made on any miniMAD happens instantly and automatically to every miniMADs: media change\*, pause, restart, playback mode, audio mode, image display-time.

*\* media change works properly if every miniMADs contain a file with the same name, even though its content is different*

Create a MadMapper project using the video-wall template, import your pictures and videos, and export the different projectors to as many synchronized miniMADs. The setup couldn't be easier: Just connect all your miniMAD with an ethernet cable to a network switch\*, and wait until they automatically synchronize.

*\* the switch is only necessary starting with 3 miniMAD devices*

# CONTROLS

## BUTTONS

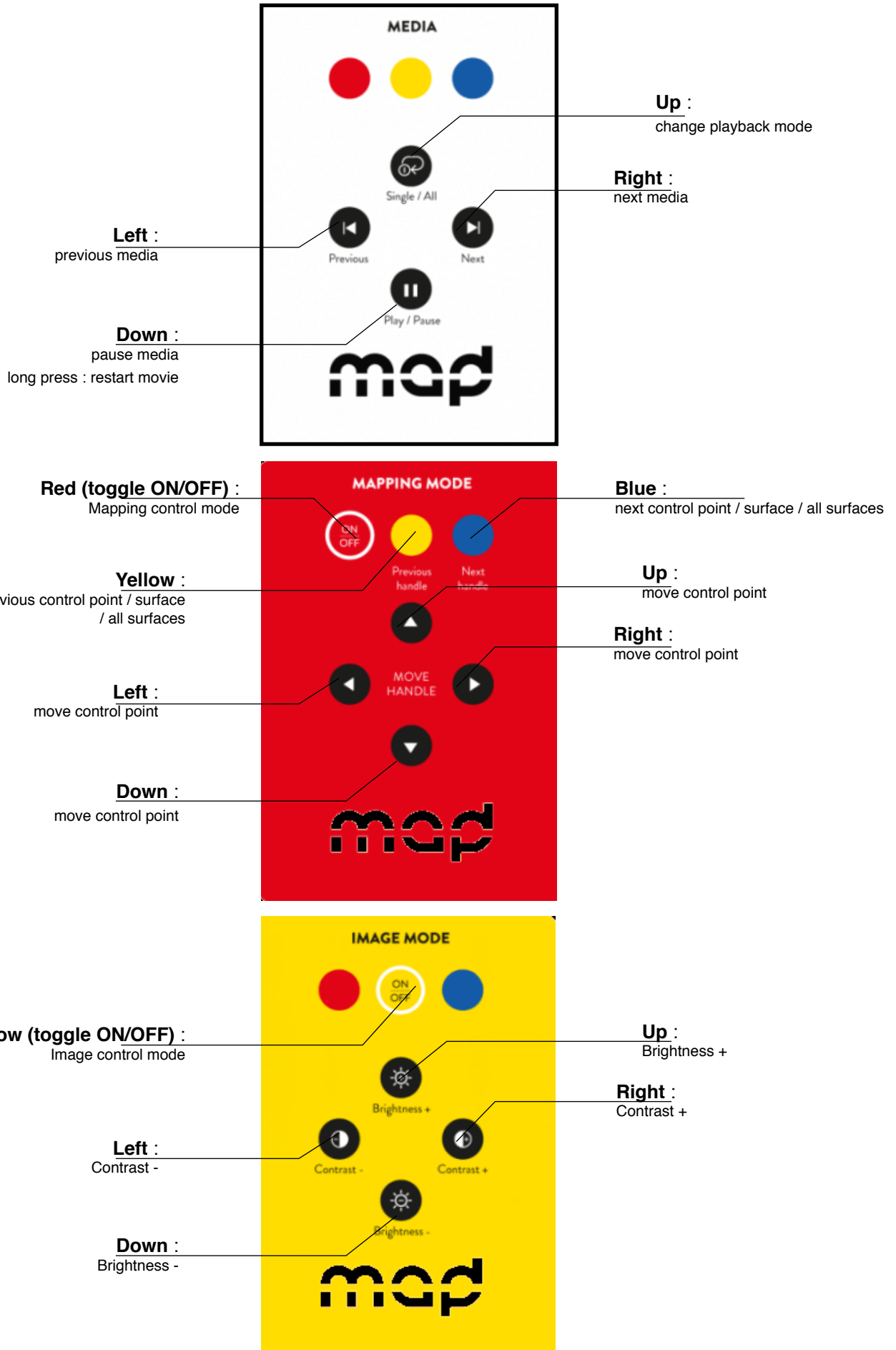

# CONTROLS

## KEYBOARD

As an alternative to the miniMAD's buttons, you can use any USB keyboard as a remote. Using a wireless USB keyboard may be particularly interesting when the device is not easily accessible. Attach the keyboard to one of the four USB ports prior to powering it on and follow the following keyboard map to control all functions:

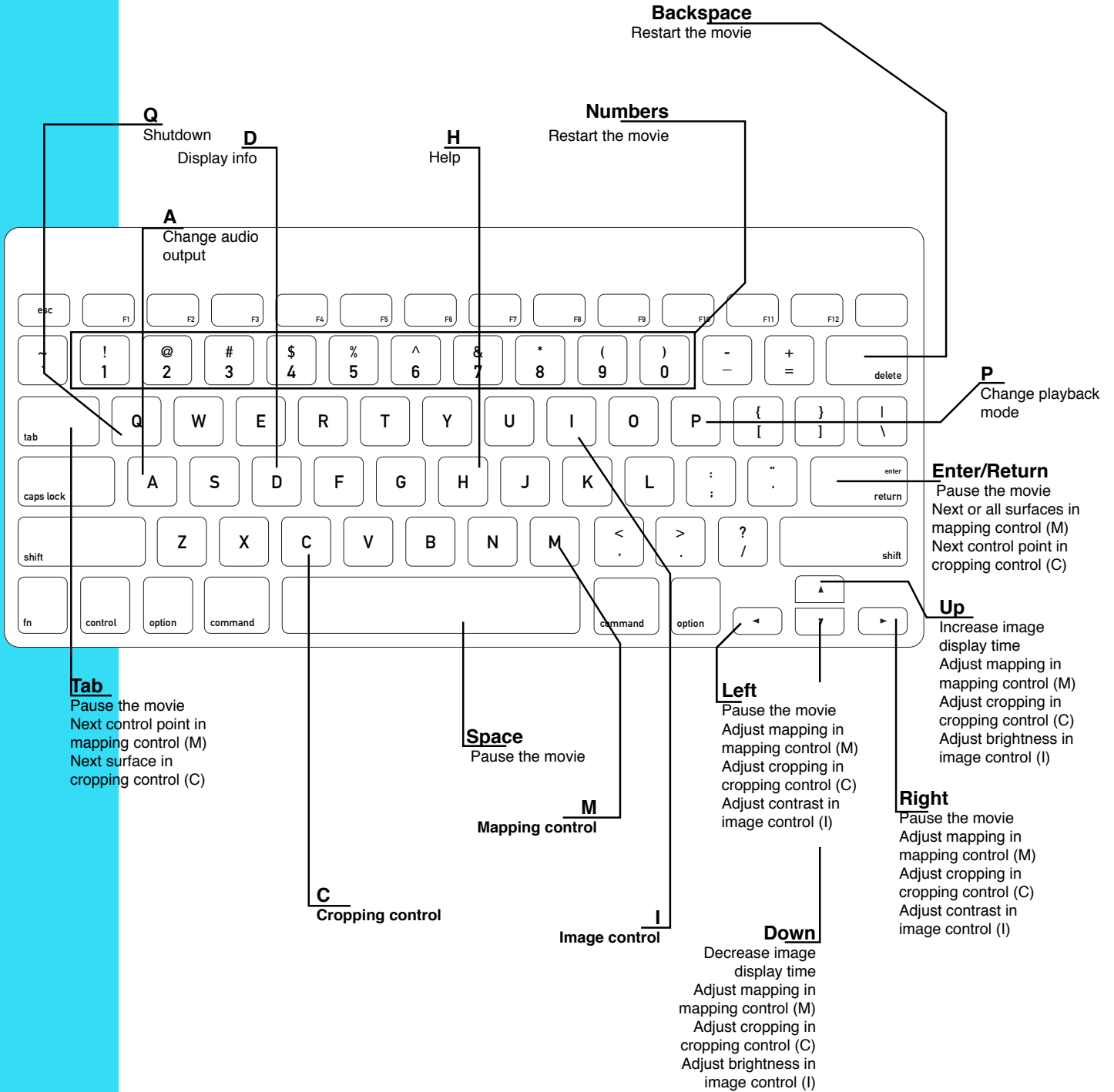

## NETWORK SYNCHRONIZATION

When connected to a network, all the miniMADs share the same media controls (media change, pause, restart, playback mode, audio mode, image display time) which means that every change that's made on any miniMAD is instantly reflected on all of them.

# SPECIFICATIONS



## TECHNICAL SPECIFICATIONS

- Raspberry Pi 2 Model B
- 7 buttons control panel
- HDMI output up to 1080p60 (1920×1080 at 60Hz)
- 16 GB MicroSD-card + adapter
- 2 Amps power supply
- Size 9x10x3 cm

## IN THE BOX:

- 1 x 16 GB microSD-card class 10 installed with miniMAD software and an SD-card adapter
- 1 x power supply 100-240V including EU, AUS, UK and US plug (you can choose a white or black unit)
- 1 x printed user-manual



## ACCESSORIES

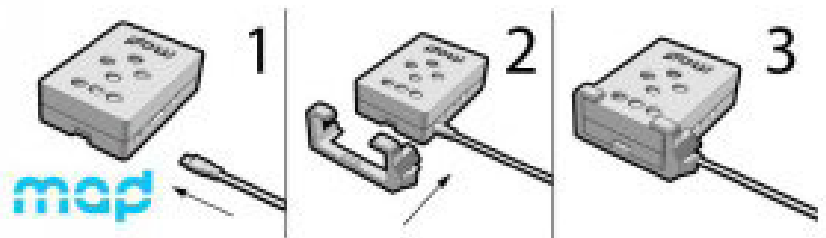
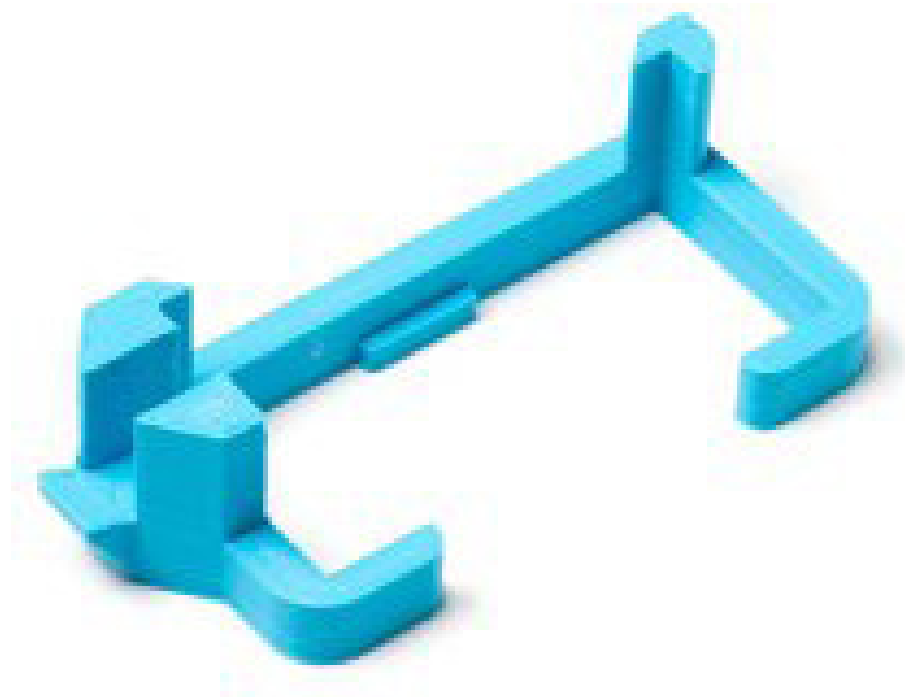

Secure your miniMAD power-plug from being disconnected or damaged with the PLOCK – Power Supply Lock. You can download the 3D file to print it yourself (Creative Commons Attribution Noncommercial Share Alike).